



## **PALAIS HANDLE ESCUTCHEON**

**STUDIO HENRY WILSON**



# PALAIS ESCUTCHEON VARIATIONS

## PASSAGE WAY

Details on page 2 & 3

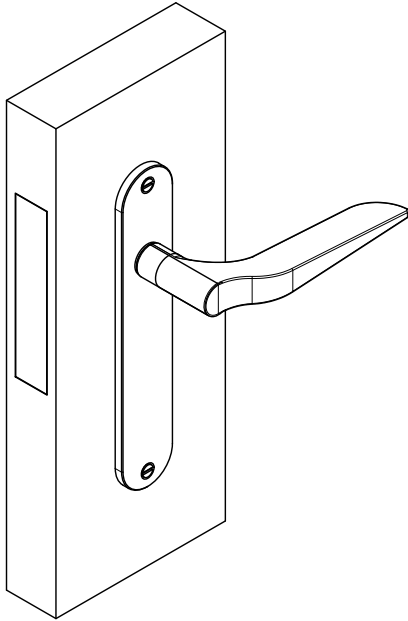

## STANDARD PRIVACY

Details on page 4 & 5

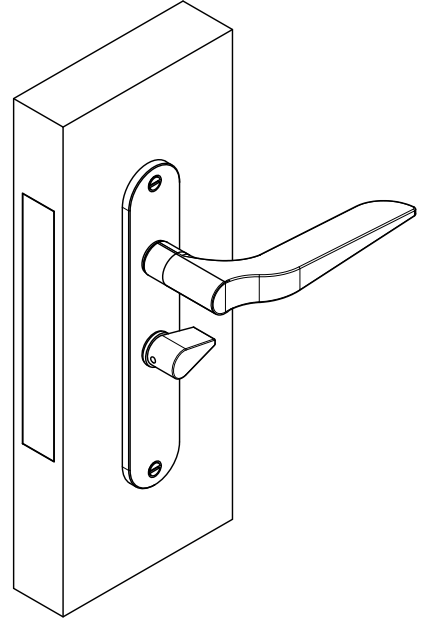

## MAGNETIC PRIVACY

Details on page 6 & 7

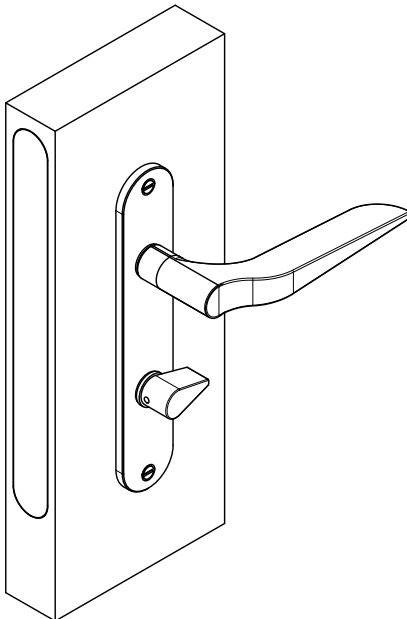

## KEY WAY

Details on page 8 & 9

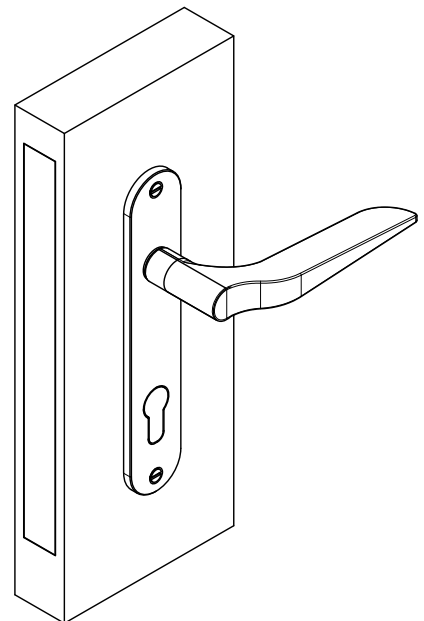

## PASSAGE WAY

**"PILL" SHAPE ROSE/ESCUTCHEON**



**"CIRCLE" SHAPE ROSE/ESCUTCHEON**



The Passageway variation suits doors with standard depth door jams. This variation is suited for internal doors where locking is not required.

The rose/escutcheon provides matches other variations to form uniform design language across all doors.

The rose/escutcheon is designed to fit a Jacksons JM60 lock body. They are based here in Australia and make beautiful inexpensive brass locks.

We strongly recommended using a double sprung lock for the brass hardware, to prevent the handles from sagging over time due to the weight of the brass.

## PASSAGE WAY

**SIDE A**

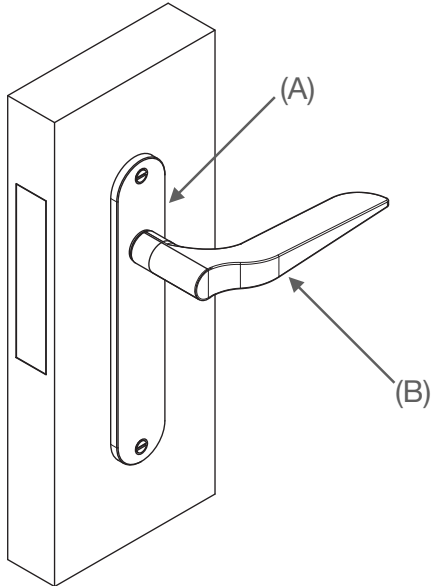

**SIDE B**

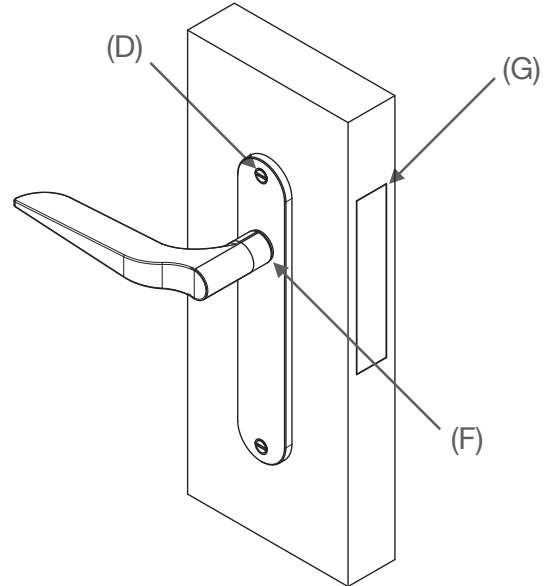

**DIMENSIONS**

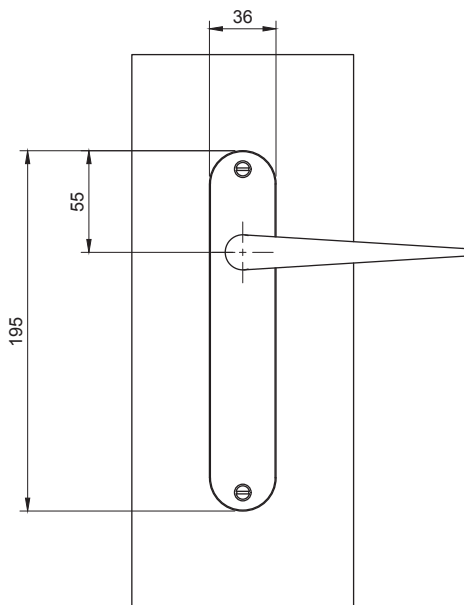

**SUPPLIED PARTS:**

- (A) 2X PASSAGE WAY ROSE/ESCUTCHEON
- (B) 2X PALAIS HANDLE (LEFT & RIGHT)
- (C) 1X PALAIS SPINDLE (NOT SHOWN)
- (D) 4X CSK ROSE/ESCUTCHEON FIXINGS
- (E) GRUB/SET SCREWS (NOT SHOWN)
- (F) 2X NYLON BUSHING
- (G) JACKSONS JM60 LOCK BODY



## STANDARD PRIVACY



The standard privacy variation suits doors with standard depth door jams. This variation is suited for internal doors where locking is required without the need for a key. This variation provides provisions for a snib and release for operating the lock mechanism.

The rose/escutcheon is designed to fit a Jacksons JM160 lock body. They are based here in Australia and make beautiful inexpensive brass locks.

We strongly recommended using a double sprung lock for the brass hardware, to prevent the handles from sagging over time due to the weight of the brass.



# STANDARD PRIVACY

**SIDE A**

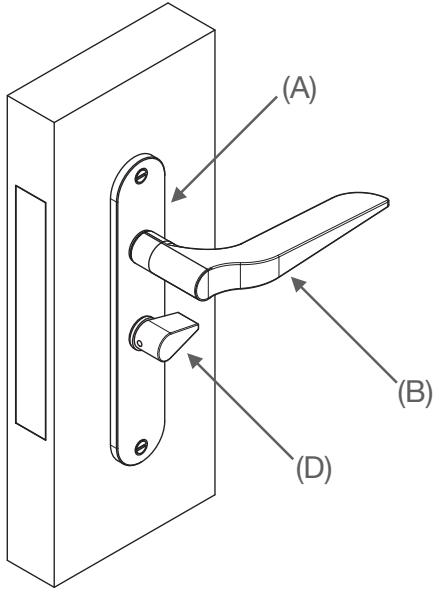

**SIDE B**

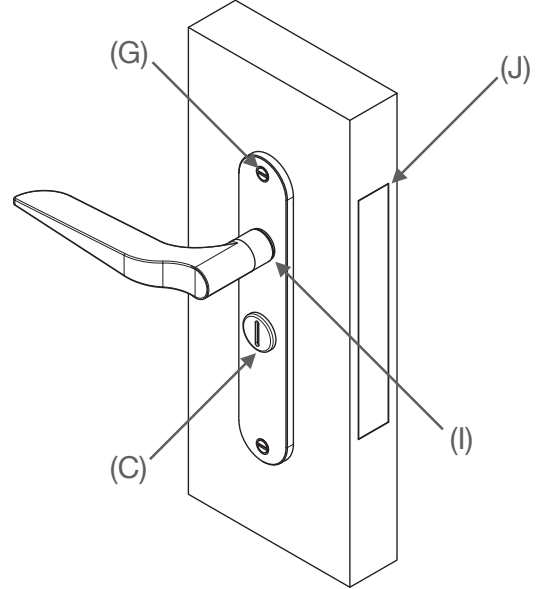

**DIMENSIONS**

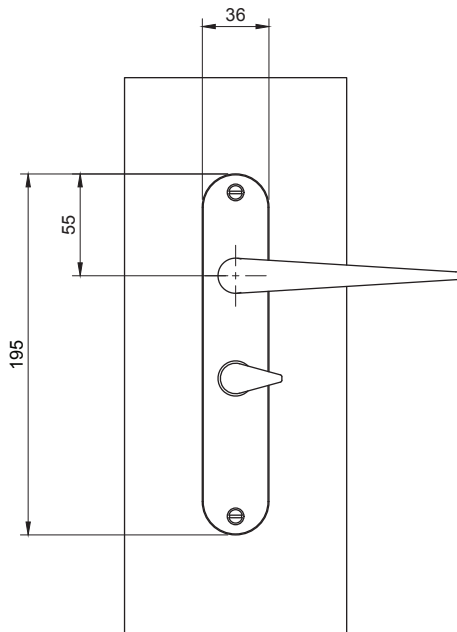

## SUPPLIED PARTS:

- (A) 2X STANDARD PRIVACY ROSE/ESCUTCHEON
- (B) 2X PALAIS HANDLE (LEFT & RIGHT)
- (C) 1X PRIVACY SNIB
- (D) 1X PRIVACY RELEASE
- (E) 1X PRIVACY SPINDLE (NOT SHOWN)
- (F) 1X PALAIS SPINDLE (NOT SHOWN)
- (G) 4X CSK ROSE/ESCUTCHEON FIXINGS
- (H) GRUB/SET SCREWS (NOT SHOWN)
- (I) 4X NYLON BUSHING
- (J) JACKSONS JM160 LOCK BODY



## MAGNETIC PRIVACY



The Magnetic privacy variation suits doors with deep door jams. This variation is suited for internal doors where locking is required without the need for a key.

This variation provides provisions for a snib and release for operating the lock mechanism.

The rose/escutcheon is designed to fit a Bonaiti BL062 Lock Body.

We strongly recommended using a double sprung lock for the brass hardware, to prevent the handles from sagging over time due to the weight of the brass.



# MAGNETIC PRIVACY

**SIDE A**

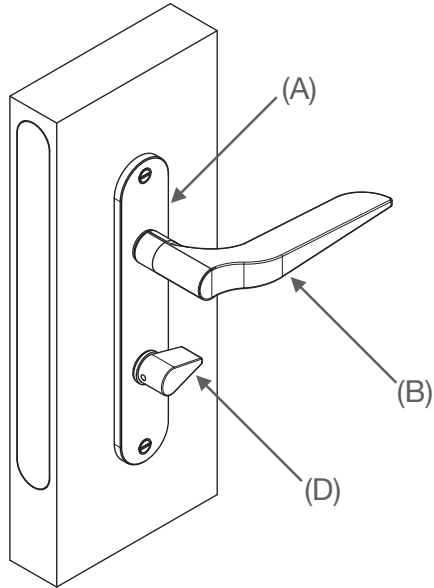

**SIDE B**

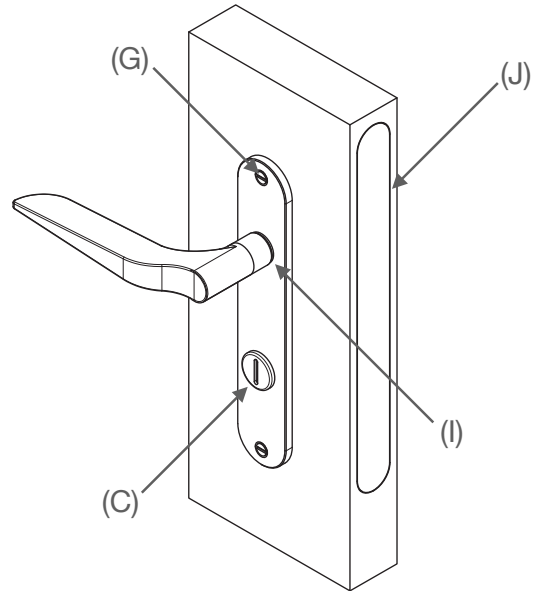

**DIMENSIONS**

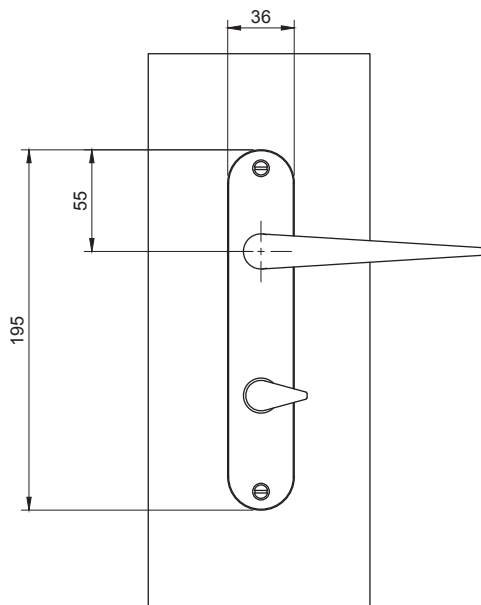

## SUPPLIED PARTS:

- (A) 2X MAGNETIC PRIVACY ROSE/ESCUTCHEON
- (B) 2X PALAIS HANDLE (LEFT & RIGHT)
- (C) 1X PRIVACY SNIB
- (D) 1X PRIVACY RELEASE
- (E) 1X PRIVACY SPINDLE (NOT SHOWN)
- (F) 1X PALAIS SPINDLE (NOT SHOWN)
- (G) 4X CSK ROSE/ESCUTCHEON FIXINGS
- (H) GRUB/SET SCREWS (NOT SHOWN)
- (I) 4X NYLON BUSHING
- (J) BONAITI BL062 LOCK BODY

## KEY WAY



The Keyway variation suits doors with standard depth door jams. This variation is suited for external doors where further security is required with the use of a key. This variation provides provisions for a euro cylinder key barrel.

The rose/escutcheon is designed to fit a Jacksons JMCL60 lock body. They are based here in Australia and make beautiful inexpensive brass locks.

We strongly recommended using a double sprung lock for the brass hardware, to prevent the handles from sagging over time due to the weight of the brass.



## KEY WAY

**SIDE A**

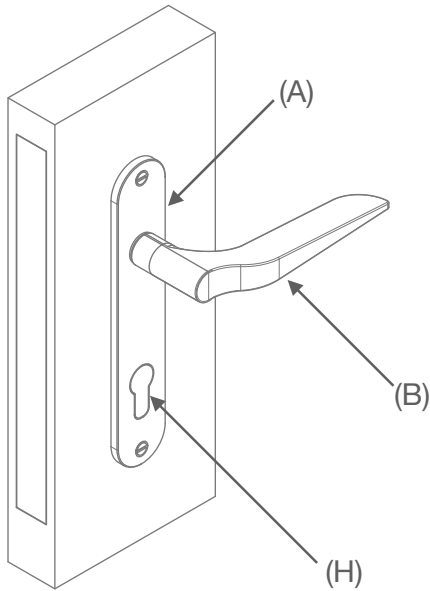

**SIDE B**

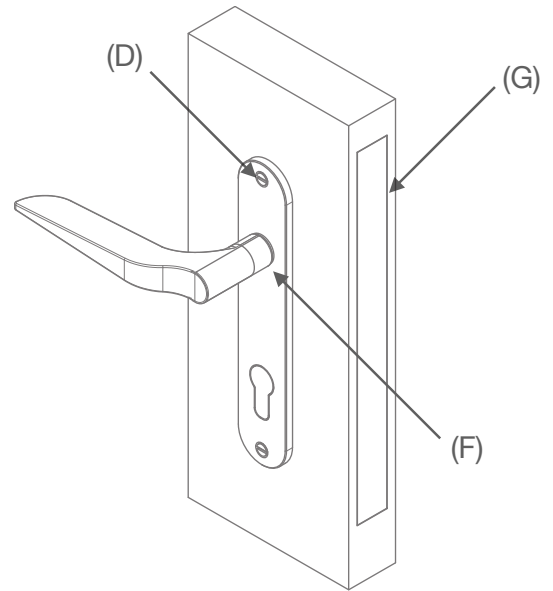

**DIMENSIONS**

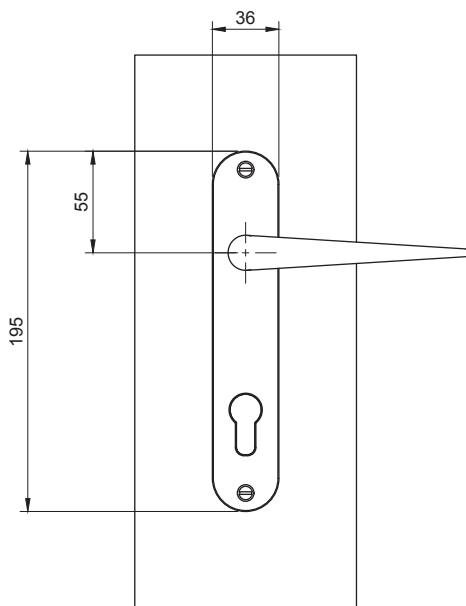

**SUPPLIED PARTS:**

- (A) 2X KEY WAY ROSE/ESCUTCHEON
- (B) 2X PALAIS HANDLE (LEFT & RIGHT)
- (C) 1X PALAIS SPINDLE (NOT SHOWN)
- (D) 4X CSK ROSE/ESCUTCHEON FIXINGS
- (E) GRUB/SET SCREWS (NOT SHOWN)
- (F) 2X NYLON BUSHING
- (G) JACKSONS JMCL60 LOCK BODY

**NOT SUPPLIED:**

- (H) EURO CYLINDER

(THIS CAN BE PURCHASED FROM KEELER HARDWARE BASED ON YOUR DOOR THICKNESS AND FINISH)

**PALAIS HANDLE VARIATIONS**  
**AVAILABLE IN**



**BRASS**



**BRONZE**



**BLACKENED**



**ALUMINIUM**



## **PALAIS HANDLE ESCUTCHEON**

**IF YOU REQUIRED ANY ASSISTANCE, PLEASE CONTACT:  
STUDIO@STUDIOHENRYWILSON.COM**