

MdV PUSH PLATE

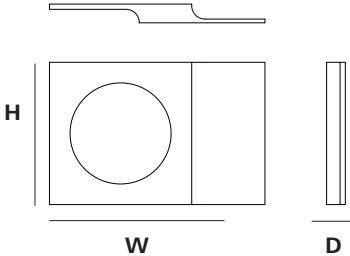

OVERALL DIMENSIONS

H 190MM x D 25MM x W 285MM
H 7.48IN x D 0.98IN x W 11.22IN



MATERIALS

I. METAL



WEIGHT

Aluminium
(1500g / 52.91oz)

Bronze / Blackened
(5000g / 176.36oz)

CLEANING INSTRUCTIONS

I. METAL

The metal used for our range oxidise with age and environment, both of which contribute to the evolution of a natural patina. If you favour the original bright finish of your pieces, this is easily restored by use of polishing solution - we recommend Braso or Silvo depending on the metal in question - applied with a soft, clean cloth.

Because each object is cast in small batches, slight variations will occur from one individual piece to another. Production marks may include slight pour ripples or surface pitting, which imprint every item with a unique character.

MDV PUSH PLATE - SINGLE

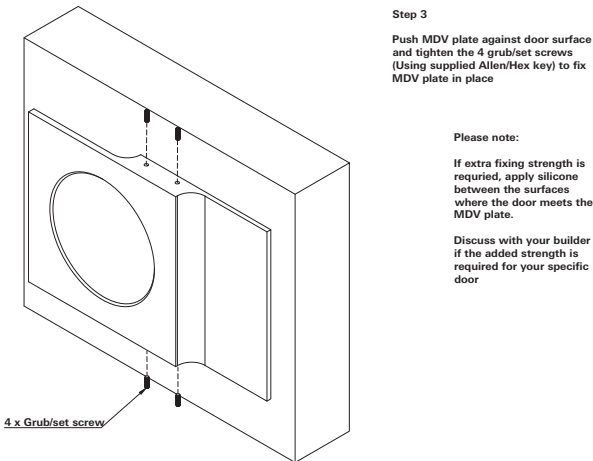
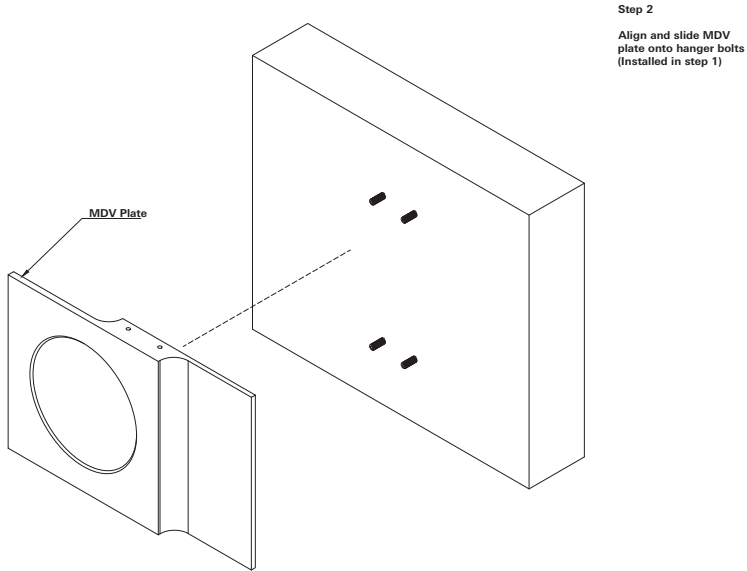
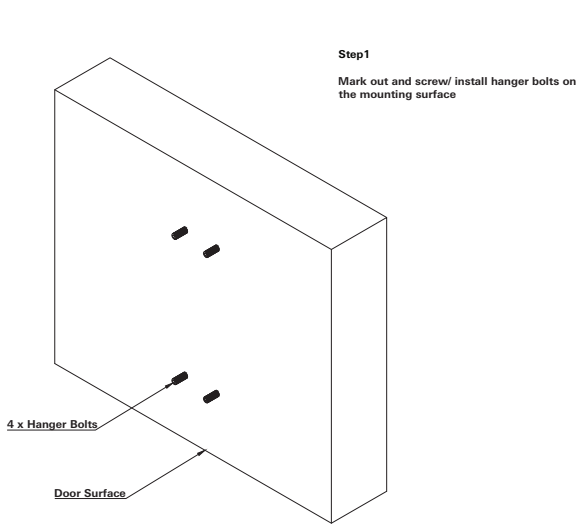

Please note:

If extra fixing strength is required, apply silicone between the surfaces where the door meets the MDV plate.

Discuss with your builder if the added strength is required for your specific door

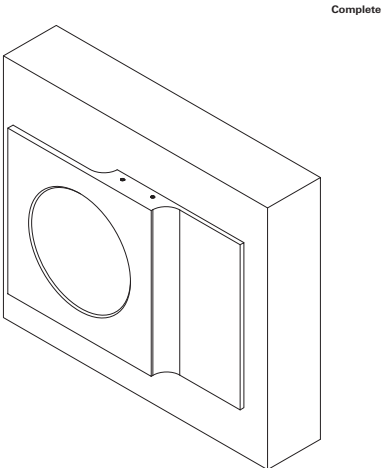

MDV PUSH PLATE - BACK TO BACK

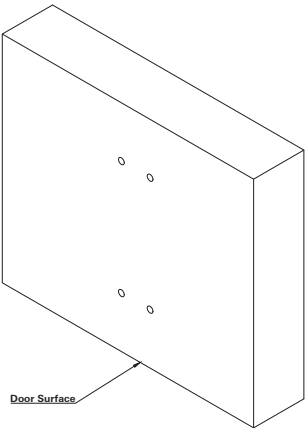

Step 1
Mark out and drill hole pattern
for the 4x threaded rods

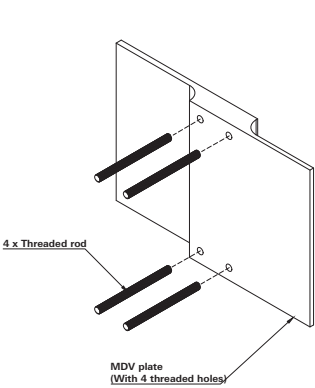

Step 2
Screw the threaded rod into the MDV plate with threaded holes

Please note:
It is recommended to use a thread locking compound to ensure that threaded rod is securely

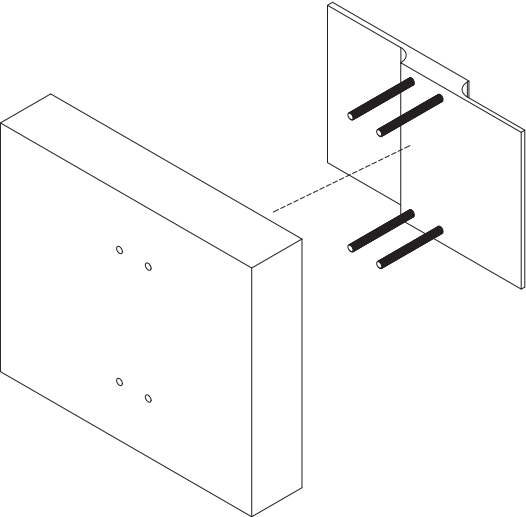

Step 3
Slide MDV plate with the threaded rods into the hole pattern from step 1

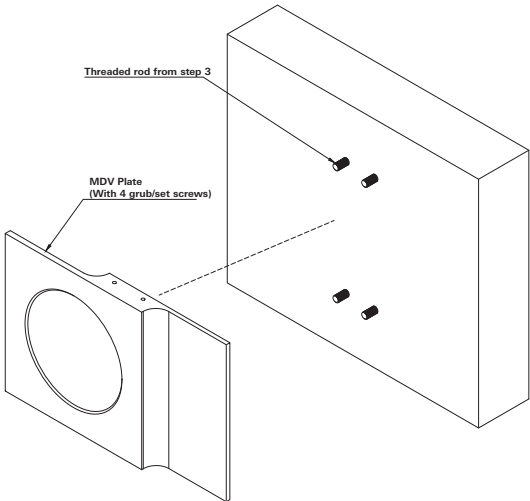

Step 4
Align and slide MDV plate with grub/set screws onto threaded rods.

Please note:
Threaded rods may need to be cut down to suit the thickness of your sepcific door.

Please test fit and cut to size so MDV plate sits flush against door and has enough length for the grub/set screws to pinch onto the rod

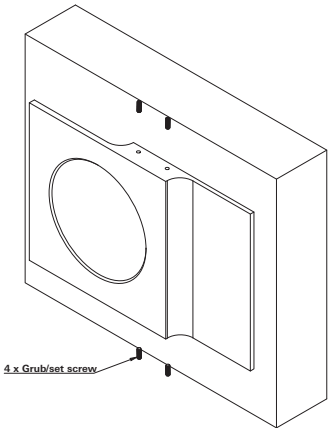

Step 5
Push MDV plate against door surface and tighten the 4 grub/set screws (using supplied Allen/Hex key) to fix MDV plate in place

Please note:
If extra fixing strength is required, apply silicone between the surfaces where the door meets the MDV plate.

Discuss with your builder if the added strength is required for your specific door