

Outdoor Elbow Install Guide

Required parts for install:

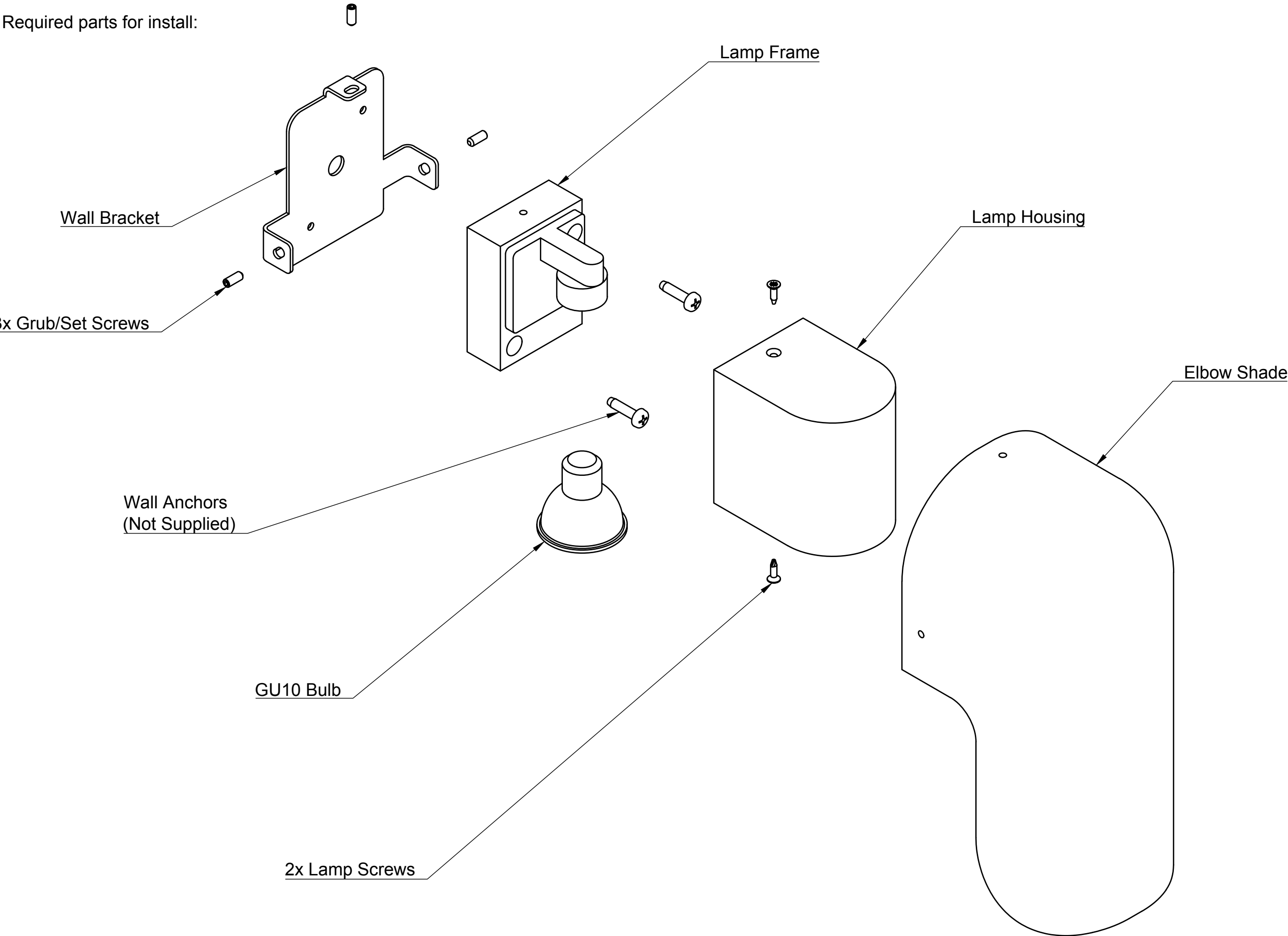

Outdoor Elbow Install Guide

Step 1 - Install wall bracket and lamp frame to wall

Using suitable wall anchors, fix the lamp frame and wall bracket to the wall. The light must be mounted in the downward orientation for outdoor use. Please ensure that the parts are installed in the orientation shown below.

Please feed the wires from the wall through the wall bracket cable pass and grommet on the lamp frame. Proceed to terminate the wires in the strip terminal on the lamp frame.

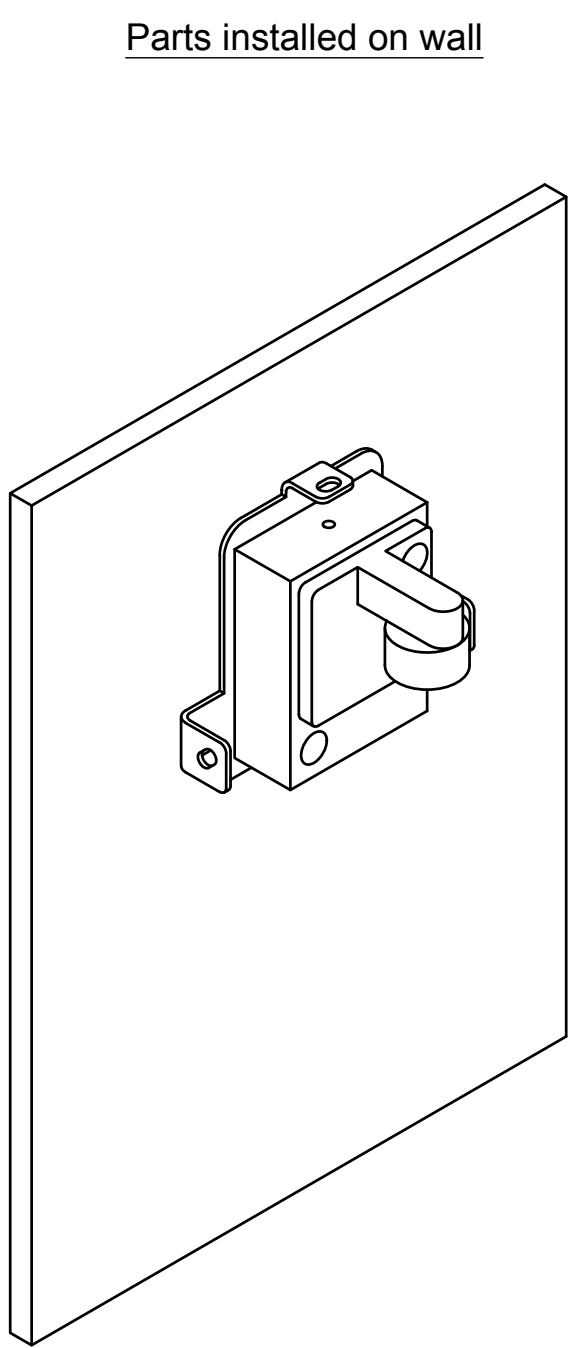
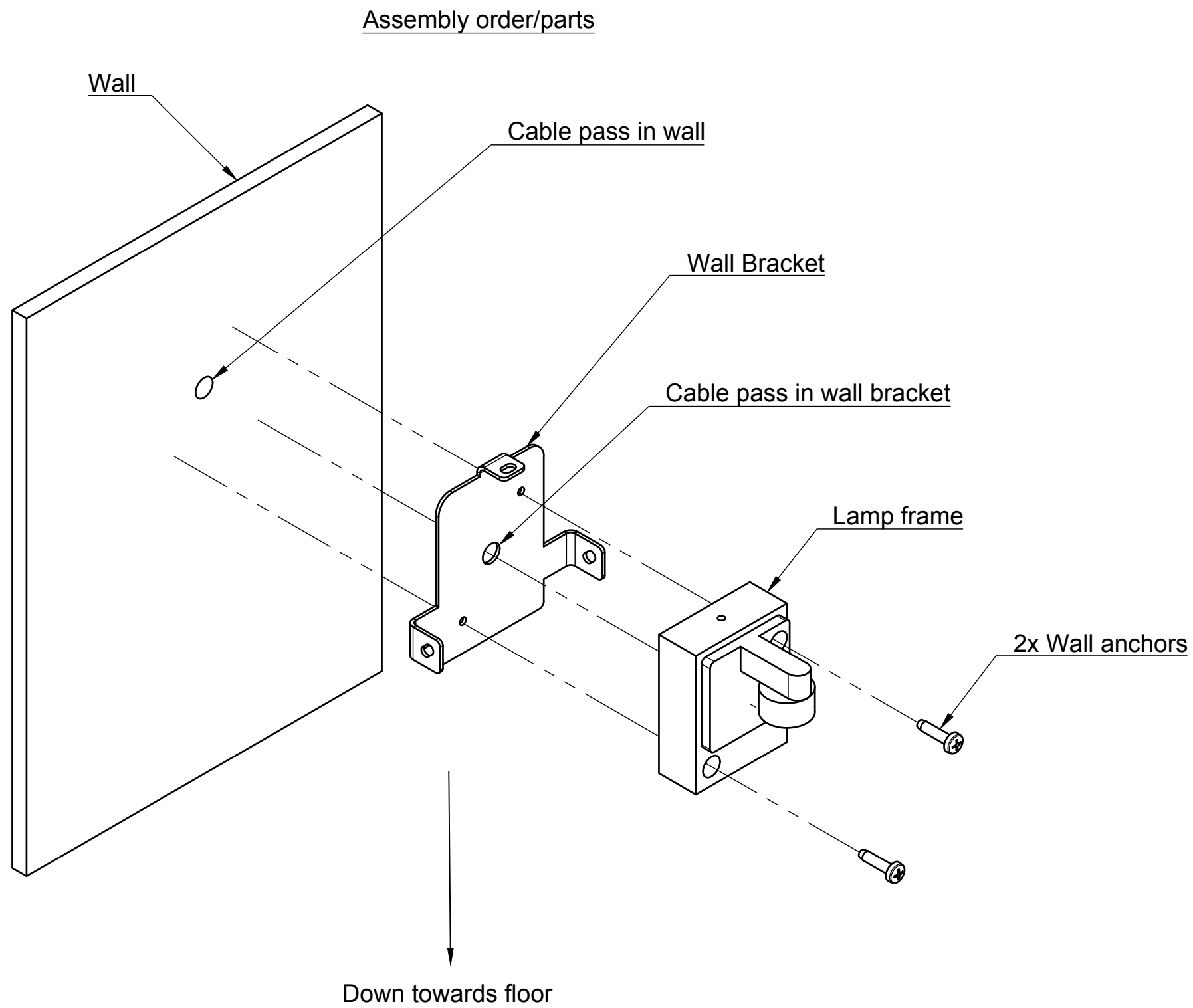

Outdoor Elbow Install Guide

Step 2 - Install GU10 bulb into lamp frame

Install GU10 light bulb that is rated for the voltage in your installing country.

Assembly order/parts

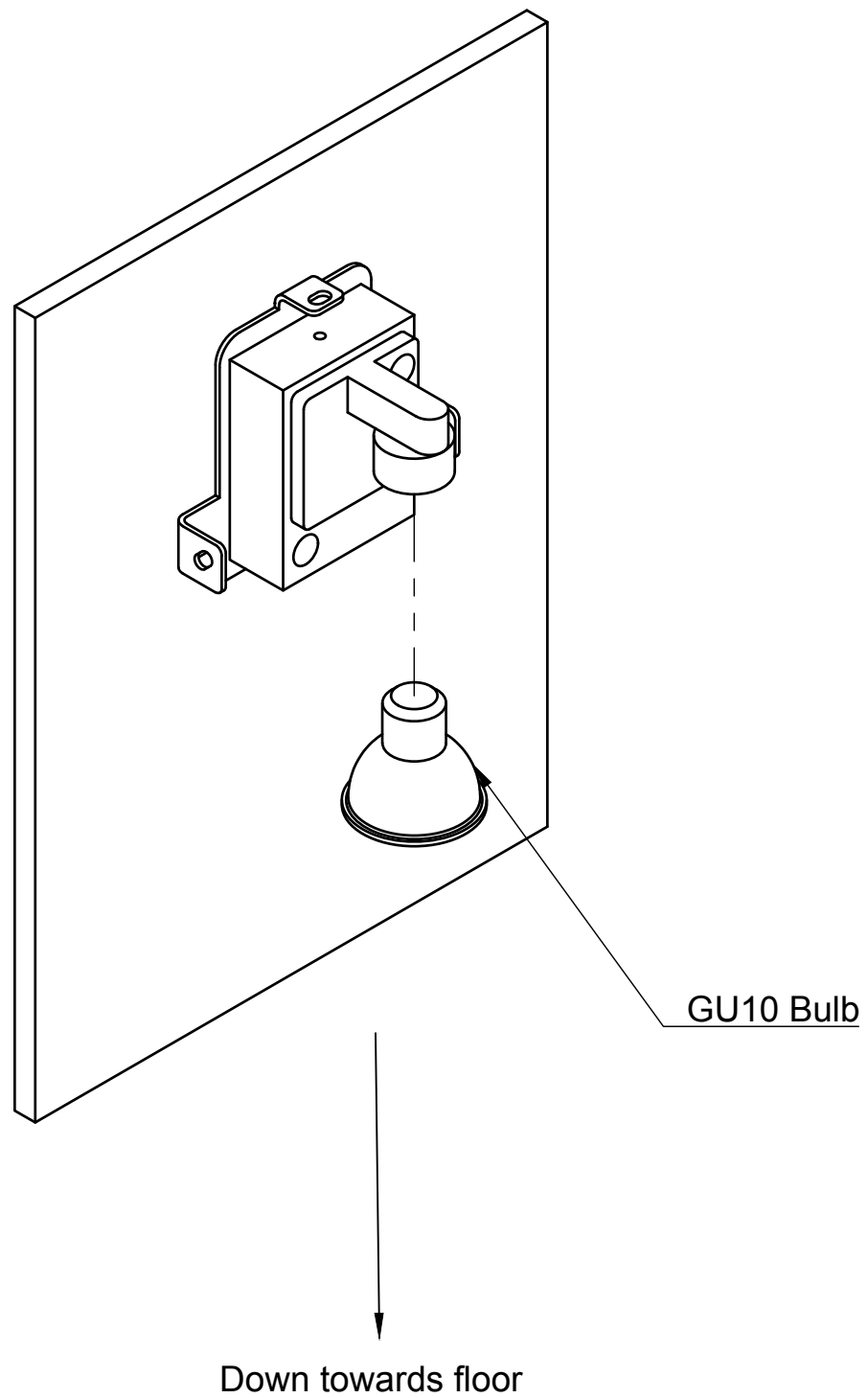

Parts installed on wall

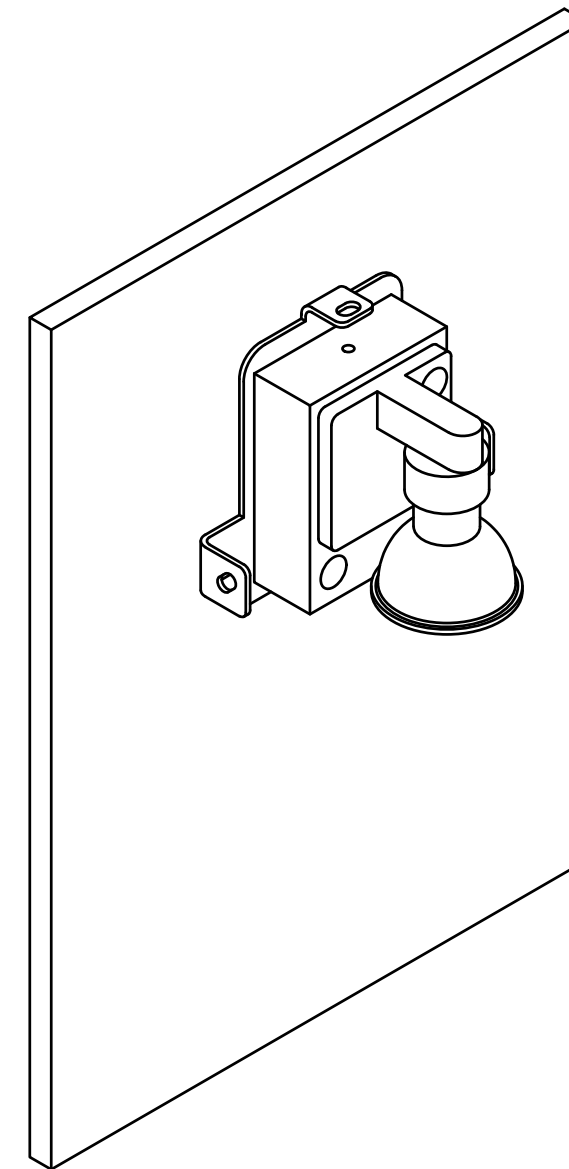

Outdoor Elbow Install Guide

Step 3 - Install lamp housing onto lamp frame

Slide lamp housing onto the lamp frame installed onto the wall from step 1.

Secure the lamp housing to the lamp frame using the supplied lamp screws

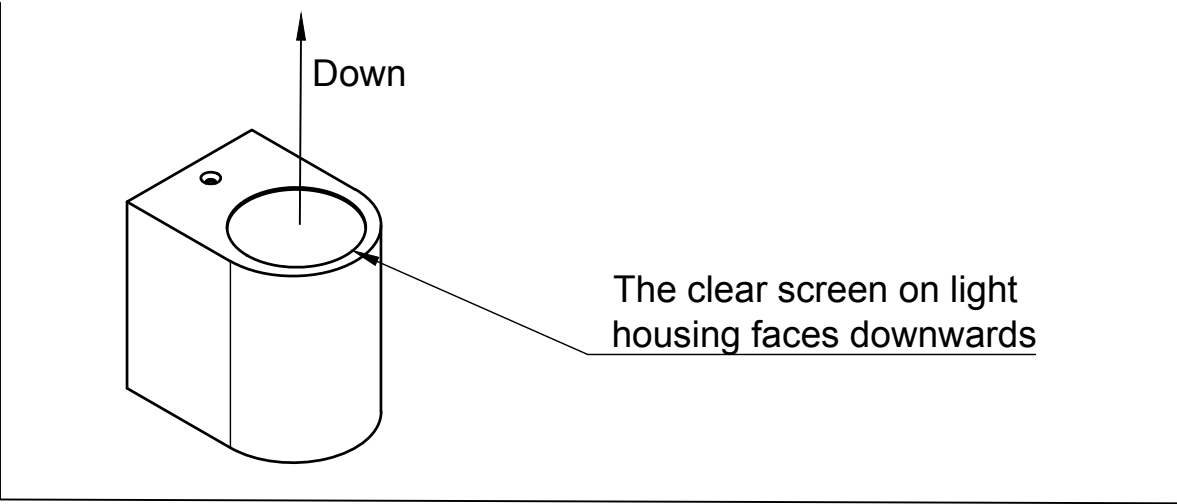

Assembly order/parts

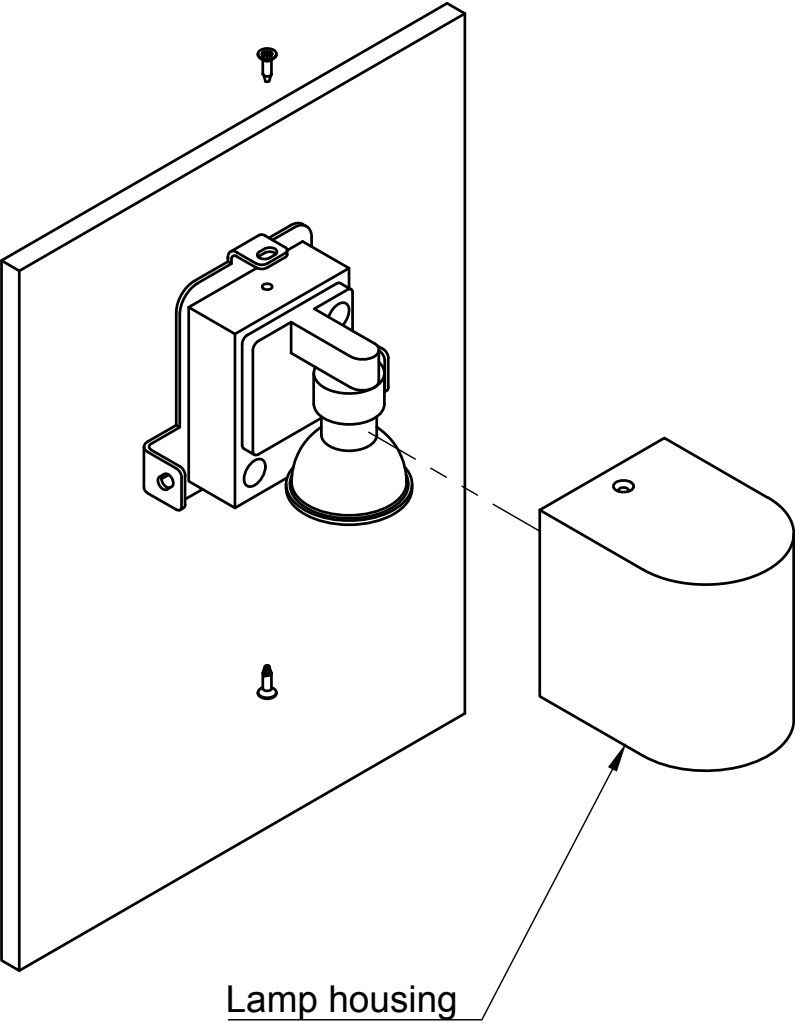

2x lamp screws

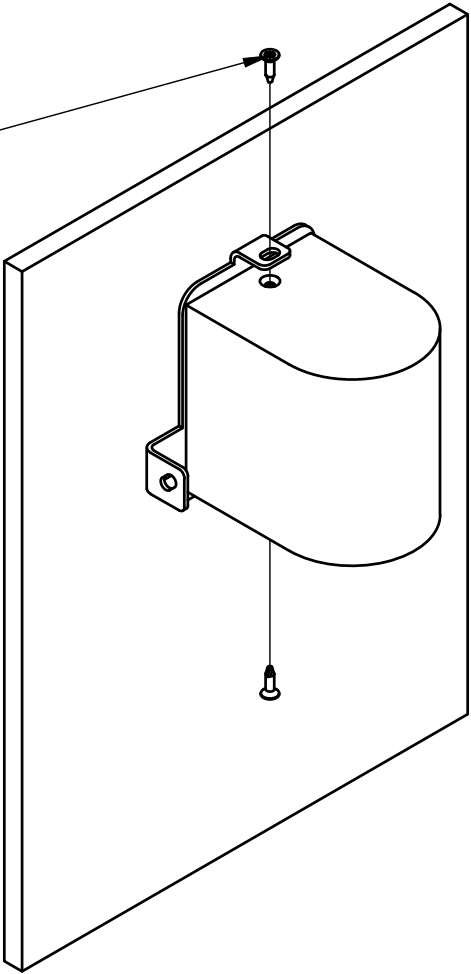

Down towards floor

Parts installed on wall

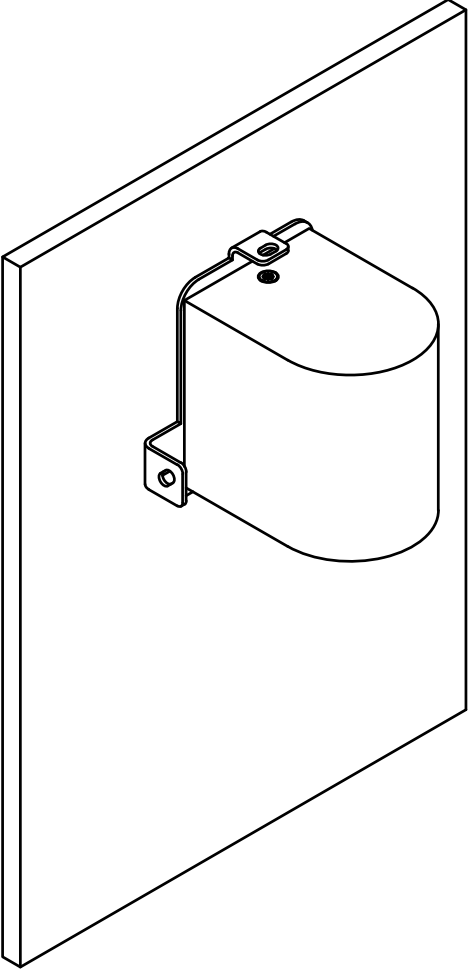

Outdoor Elbow Install Guide

Step 4 - Install elbow shade onto wall bracket

Slide elbow shade over the wall bracket. Hold the elbow shade in place and install the 3 supplied grub/set screws. The grub/set screws will secure the shade to the wall bracket. Ensure the grub/set screws are fastened flush with the outside surface of the shade

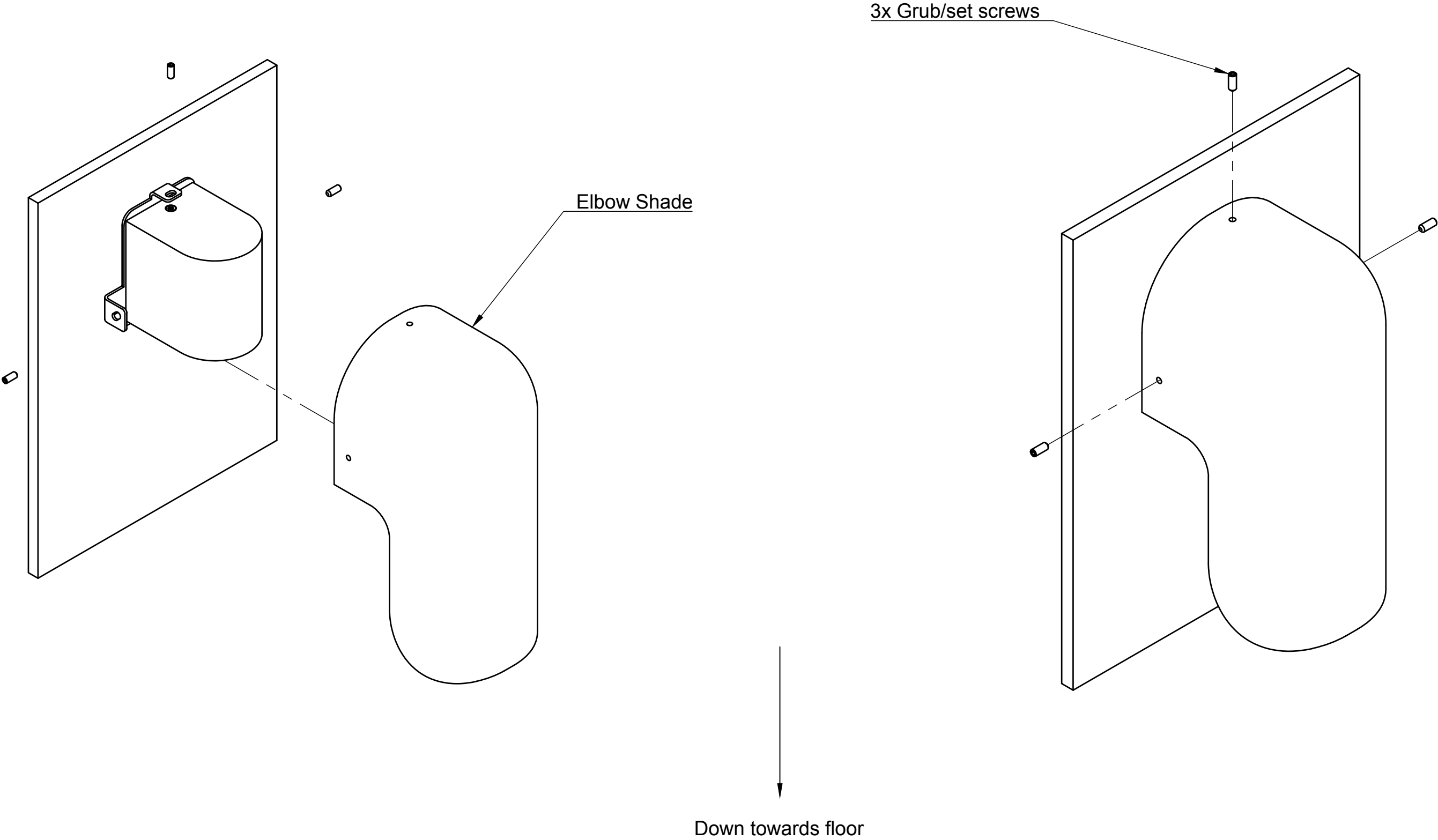

Outdoor Elbow Install Guide

Step 5 - Install is complete

