

LAKER

Assembly Guide —

Louvre Light



Thank you for choosing Laker Studio! Please confirm that all components shown in this guide are included. If anything is missing, let us know—it's rare, but it can happen. With proper care, your fixture will last a lifetime. For any questions, contact us at info@laker.studio.

CAUTION! Electrical shock risk. Turn off electrical power at the main fuse box or circuit panel before beginning installation, servicing the light, or installing accessories. We recommend working with a qualified electrician familiar with the type of work you'd like done.

LOUVRE LIGHT Components

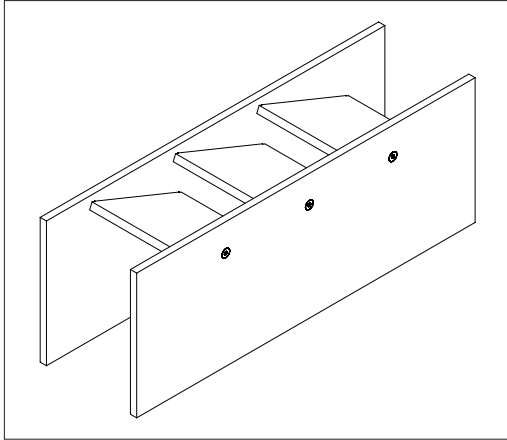

PART NAME
MATERIAL
DIMENSIONS

SHADE
ALUMINIUM/ WALNUT
77W X 100D X 270H

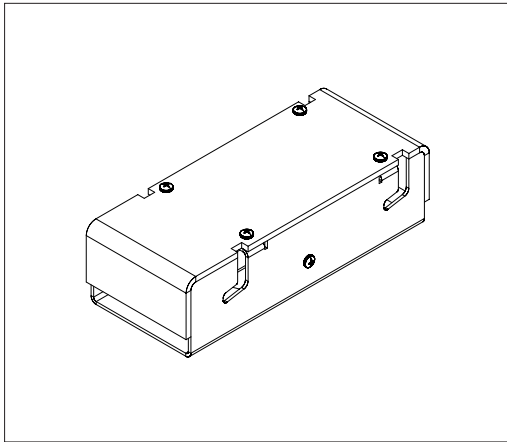

PART NAME
MATERIAL
DIMENSIONS

LED ASSEMBLY
STEEL, ACRYLIC
66W X 43D X 150H

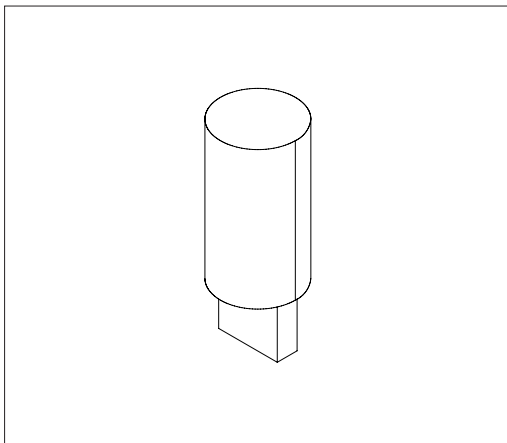

PART NAME
MATERIAL
DIMENSIONS

G9 LED
-
-

STEP 1

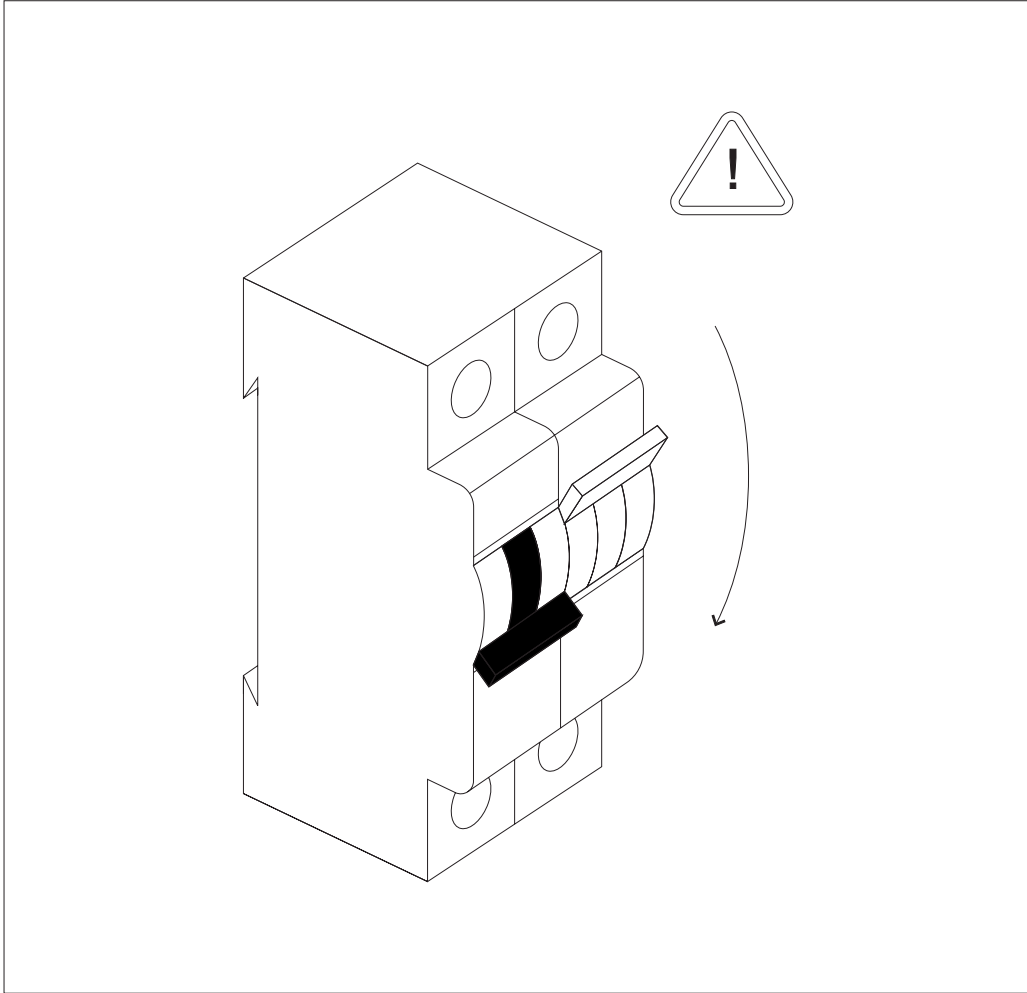

Before beginning installation, turn off electrical power at the main fuse box or circuit panel.

STEP 2

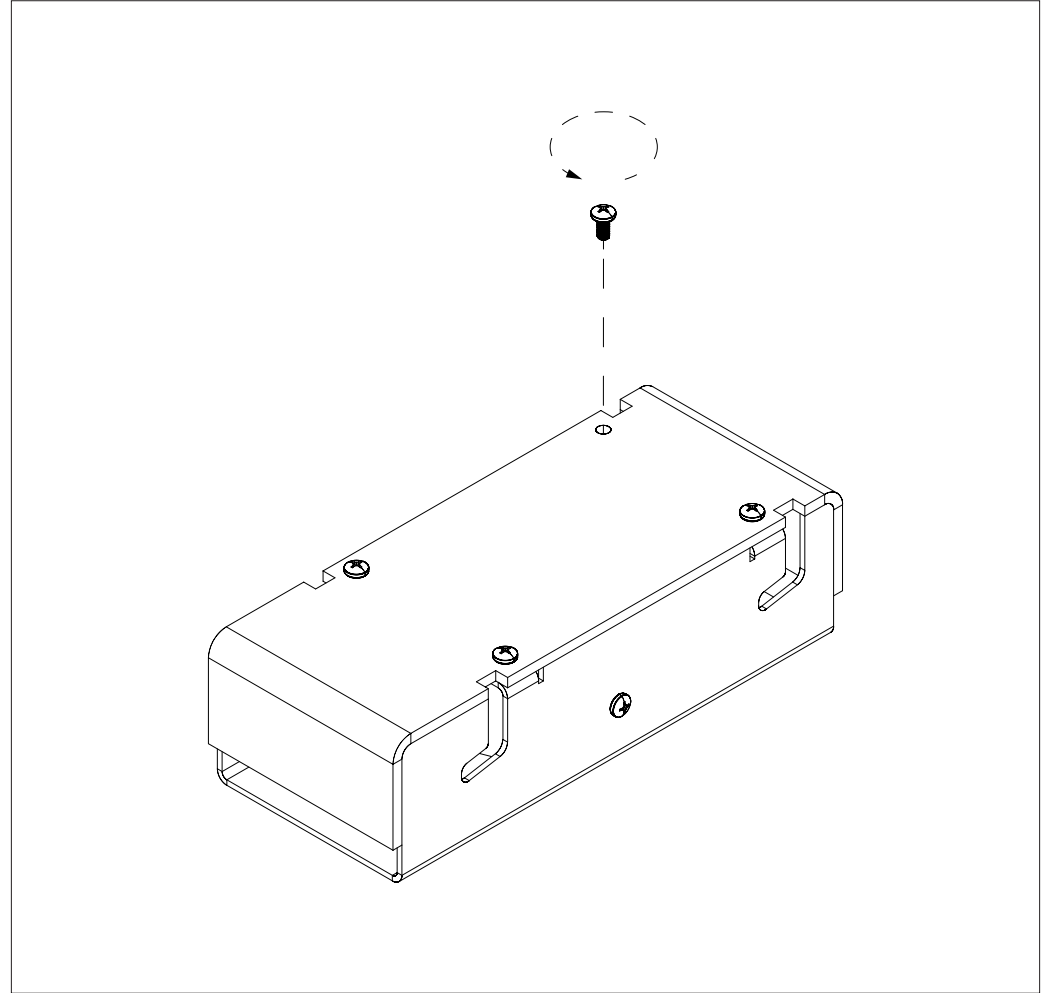

Remove the LED diffuser panel by unscrewing the machined screws.

STEP 3

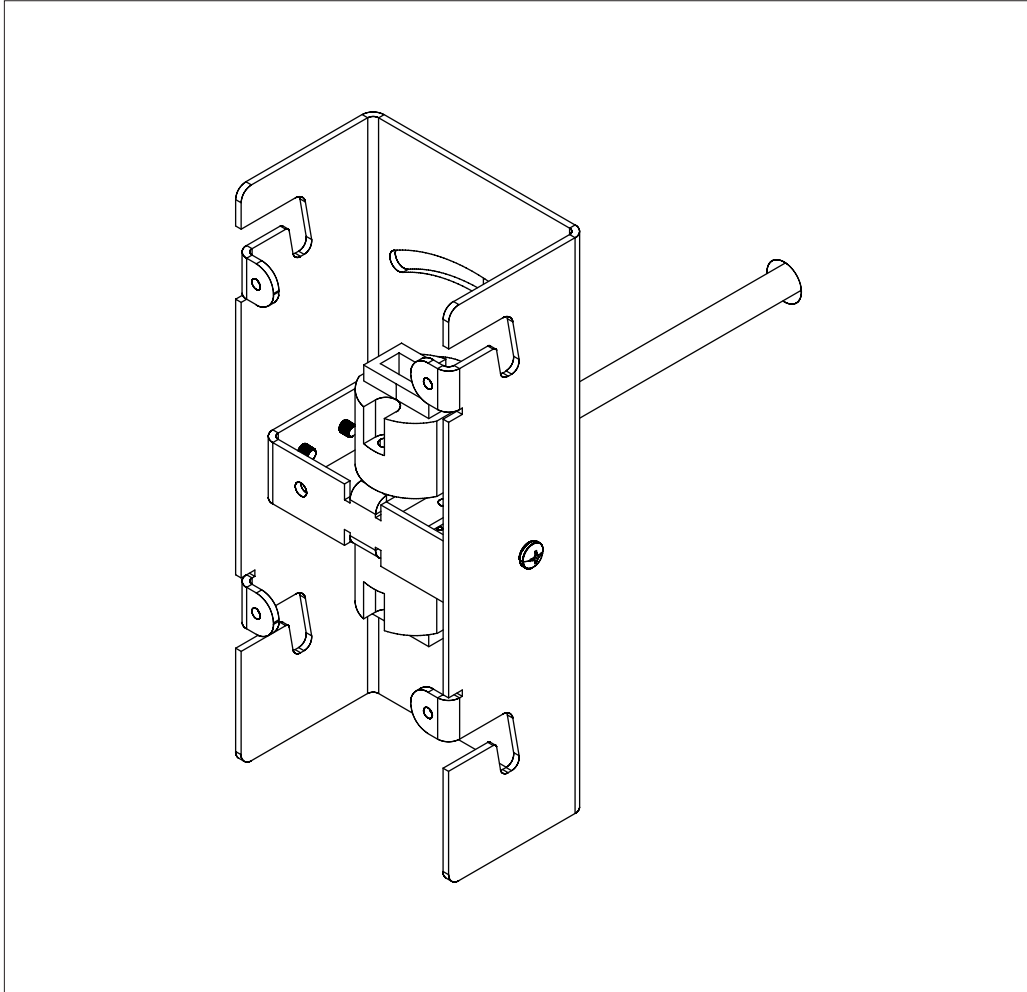

Connect the fixture's wires to the corresponding wires from the junction box in the wall. If needed use a wire stripper to remove insulation from each wire before inserting them into the corresponding junction box. To be performed by qualified professional.

STEP 4

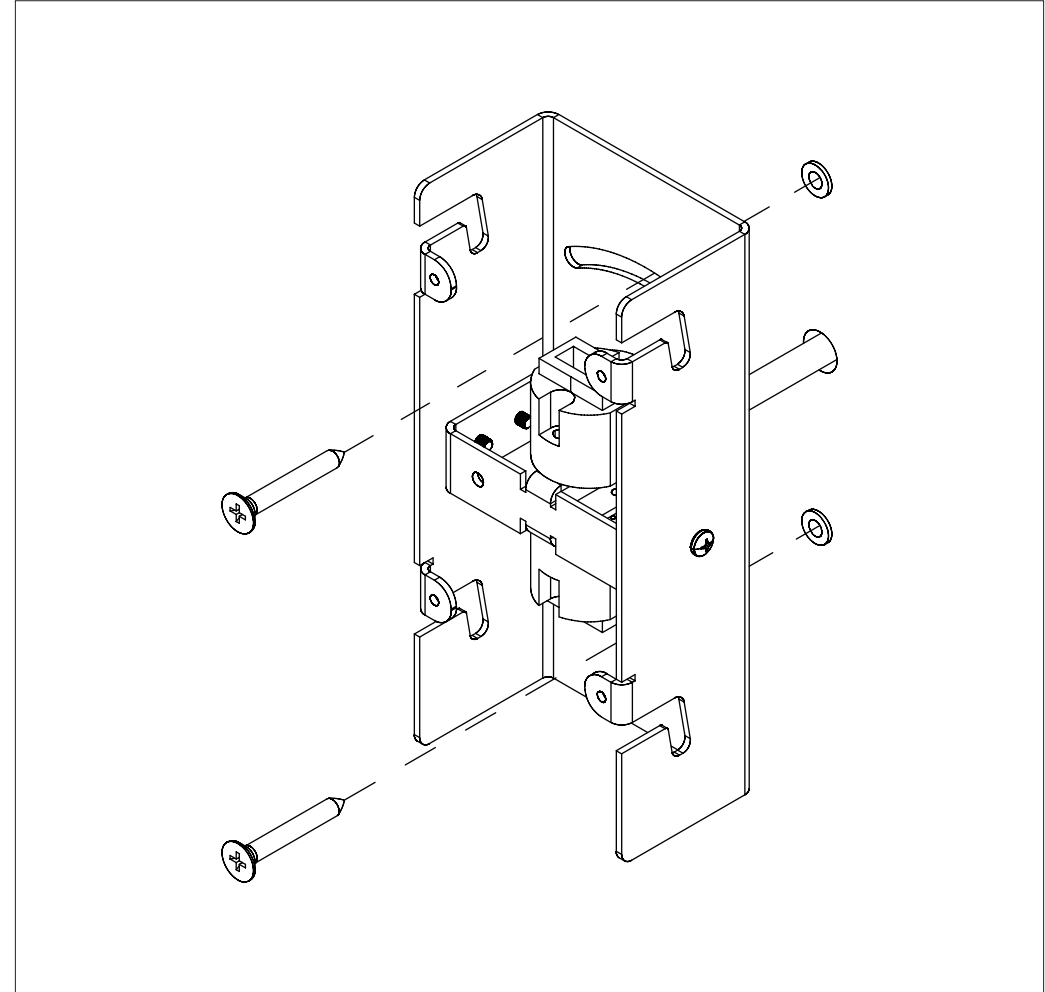

Fix the LED assembly to the wall using anchors and fixings appropriate for your wall material. Consult a qualified professional if needed.

STEP 5

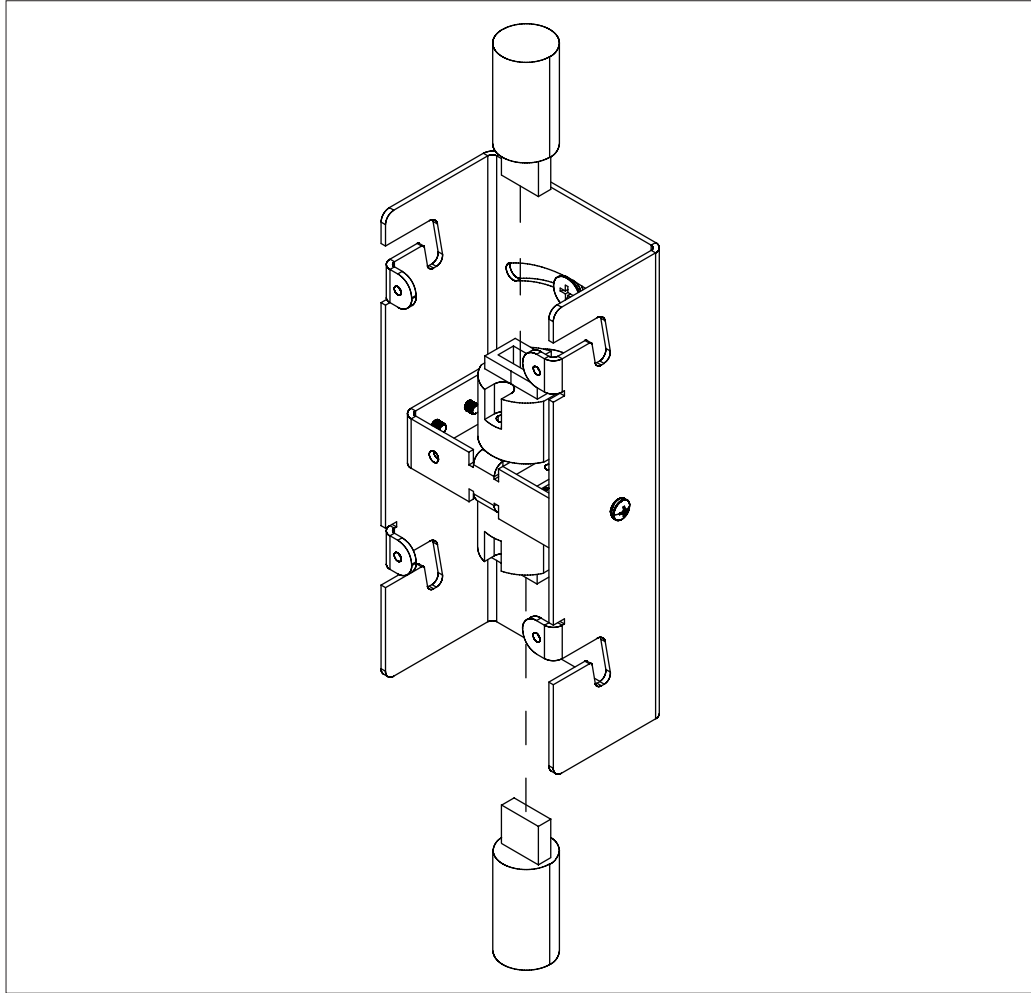

Insert the provided G9 LED bulbs into the G9 lamp holders.

STEP 6

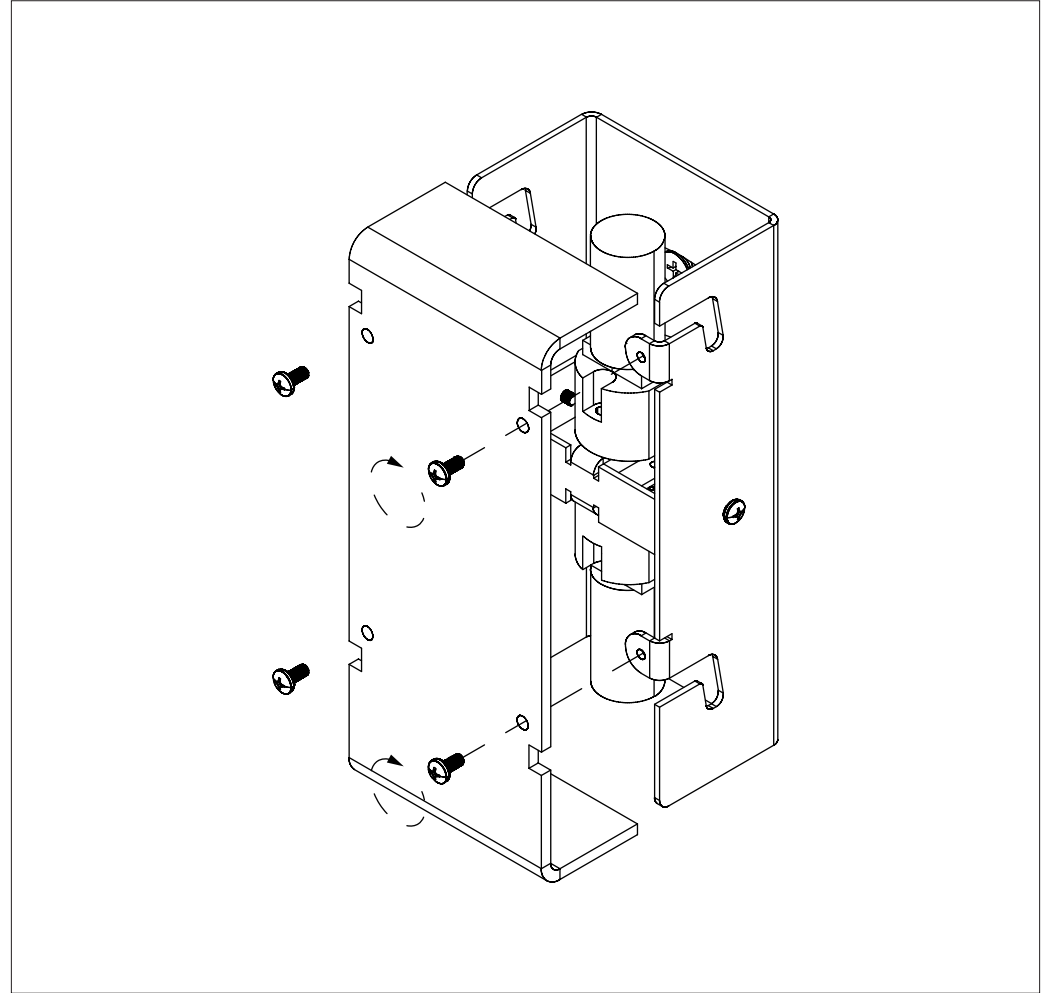

Mount the LED diffuser to the LED assembly with the previously removed machined screws

STEP 7

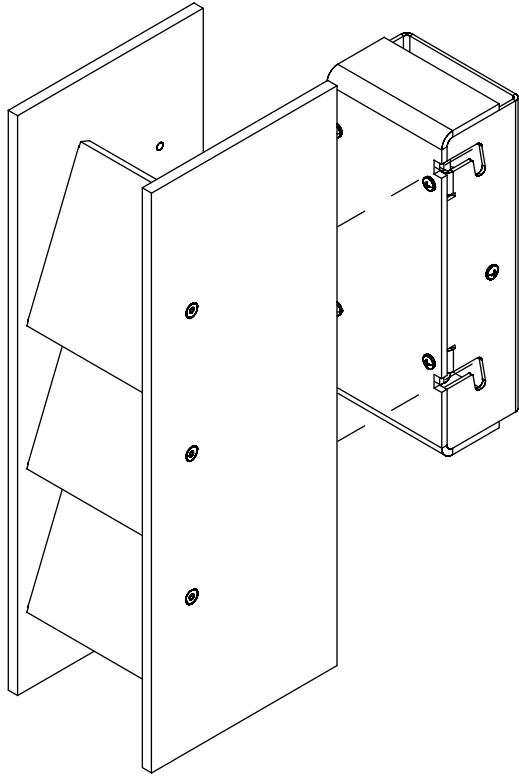

Mount the shade to the LED assembly. Secure with the provided grub screw if needed.

STEP 8

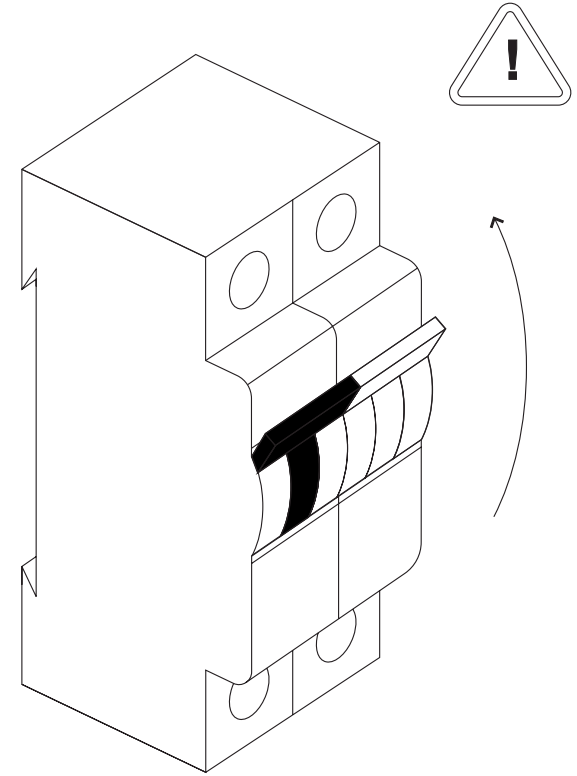

Turn the power back on at the main fuse box or circuit panel you disabled before installation.

CARE INSTRUCTIONS

To maintain cast metal surfaces, dust regularly with a soft, lint-free cloth. For deeper cleaning, use a damp cloth with mild soapy water, avoiding harsh chemicals and abrasive pads that can scratch or tarnish. A non-abrasive metal polish can be used occasionally to restore shine.

For varnished timber, wipe with a soft, dry cloth to remove dust. Use a slightly damp cloth for cleaning, followed by immediate drying, and avoid abrasive or acidic cleaners. Protect from heat and moisture by using coasters and keeping out of direct sunlight to prevent fading.

Place felt pads under items to avoid scratches, and lift rather than drag any heavy objects to protect both surfaces. Following these steps will help keep your cast metal and timber finishes looking pristine.

RETURNS POLICY

Please note that the following terms apply to all returns: Our returns policy allows for exchanges, but not refunds. If you want to return a piece for exchange, you must do so within 30 days of purchase. To be eligible for exchange, your item must be returned to Laker Studio unused, in the same condition in which you received it, and in the original packaging. We also require a receipt as proof of purchase. To return your product, please send it by post or courier to: 3/82 Myrtle street, Chippendale NSW 2008. Please note that customers are responsible for return shipping costs, and that these costs are non-refundable.

Replacements are offered only if your purchased item is defective or damaged when it arrives. Should this happen, please return the item to us at the address above; please also send an email advising us of the problem.

The time it takes for an exchange or replacement item to reach you will depend on your location, but we will make every attempt to get it to you promptly.

If you are returning an item priced at more than \$75, we strongly recommend that you use a trackable shipping service or purchase transit insurance, as we cannot guarantee that we will receive your returned item.

(E. info@laker.studio)
(P. (02) 9199 9658)
(A. 3/82 Myrtle Street, Chippendale NSW 2008)